

Version Number: D

PRODUCT SPECIFICATION

Part Number: A2503

- HOUSING
- ◆ Material: Nylon 66 UL 94V-0

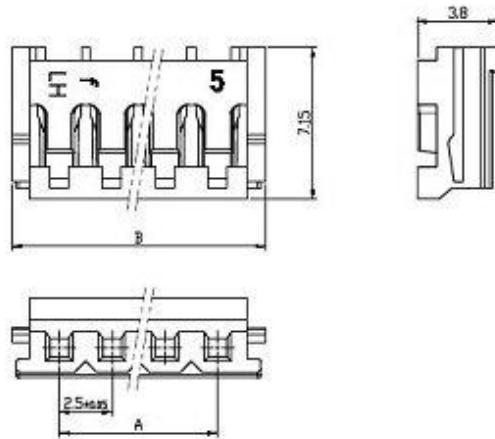

| Poles | Part No. | Dimensions mm | |
|-------|-----------|---------------|------|
| | | A | B |
| 2 | A2503-H02 | 2.50 | 7.0 |
| 3 | A2503-H03 | 5.00 | 9.5 |
| 4 | A2503-H04 | 7.50 | 12.0 |
| 5 | A2503-H05 | 10.00 | 14.5 |
| 6 | A2503-H06 | 12.50 | 17.0 |
| 7 | A2503-H07 | 15.00 | 19.5 |
| 8 | A2503-H08 | 17.50 | 22.0 |
| 9 | A2503-H09 | 20.00 | 24.5 |
| 10 | A2503-H10 | 22.50 | 27.0 |
| 11 | A2503-H11 | 25.00 | 29.5 |
| 12 | A2503-H12 | 27.50 | 32.0 |
| 13 | A2503-H13 | 30.00 | 34.5 |
| 14 | A2503-H14 | 32.50 | 37.0 |
| 15 | A2503-H15 | 35.00 | 39.5 |
| 16 | A2503-H16 | 37.50 | 42.0 |

- TERMINAL

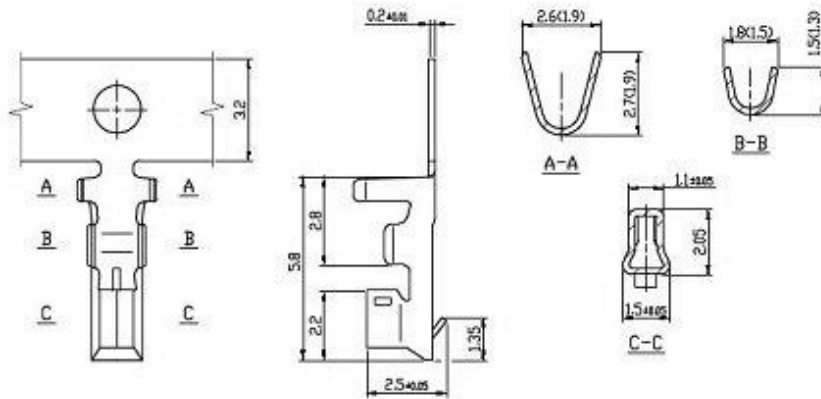

| Part No. | Wire Range | Insulation O.D | Material | Finish | Qty/reel |
|------------|----------------|----------------|-----------------|------------|-----------|
| A2503A-TP2 | AWG #30 to #22 | 1.0 to 1.9mm | Phosphor bronze | Tin-plated | 8,000pcs |
| A2503B-TP2 | AWG #32 to #28 | 0.5 to 1.1mm | Phosphor bronze | Tin-plated | 10,000pcs |